

ROMAN SHADES

LIFT SYSTEMS: CORDLESS LIFT



The difficulty level of this installation is ranked at **Level 1**. A piece of cake!

If you have questions or get stuck, call our Customer Care Team at 888-685-1735, or email info@selectblindscanada.ca

HARDWARE AND PARTS INCLUDED

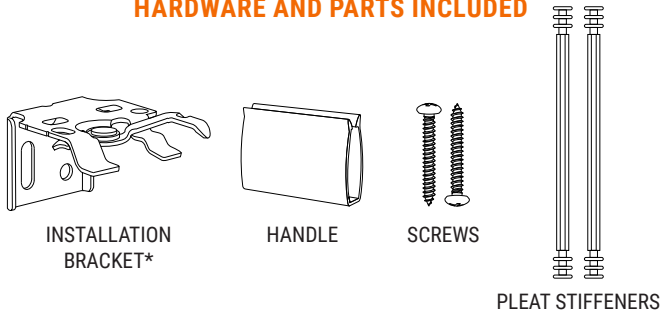

*The quantity of brackets you receive will depend on the width of your roman shade.

TOOLS REQUIRED

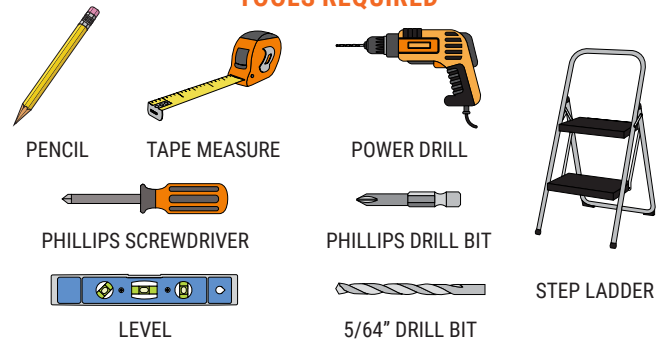

1. MOUNTING THE BRACKETS

ATTACH THE PLEAT STIFFENERS

NOTE: Cordless shades are lifted and lowered manually. Pleat stiffeners are used to make sure your shade operates and folds together perfectly. We recommend attaching the pleat stiffeners before mounting your brackets.

1. On the backside of the shade, locate the plastic braces attached to the bottom corners of the shade.
2. Press each end of the stiffener into the grooves on the plastic brackets. DO NOT press on the center of the stiffeners. This can break them.

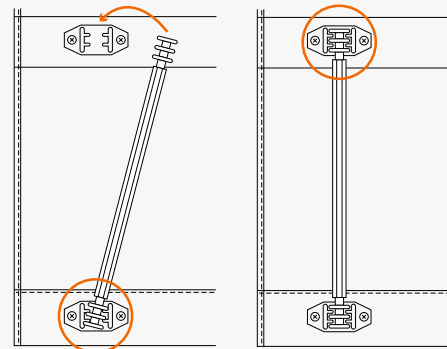

INSIDE MOUNT

1. Measure 2" - 4" in from each side of the window frame, and mark once with a pencil for your outer brackets. The front of the bracket will face out from the window, and the back of it will hang down parallel to the window.

NOTE: Leave marks for any additional brackets you need, evenly spaced between your first two marks.

2. Center the brackets over your marks, and set them back until the front of the bracket meets the edge of your window. Mark through the top holes in the bracket with your pencil. This is where your screws will go.

3. At each of your marks, pre-drill holes with a 5/64" drill bit. Align each bracket with your screw holes and drill the screws securely into place.

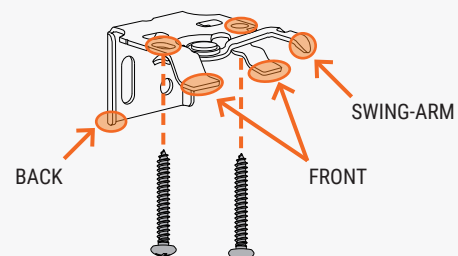
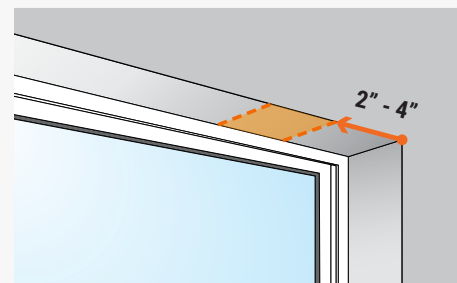

OUTSIDE MOUNT

1. Measure 2" - 4" in from each side of the window frame. From here, measure upward another 2" - 4", and make a pencil mark.

NOTE: Leave marks for any additional brackets you need, evenly spaced between your first two marks and at the same height.

2. Center the top edge of the brackets on your marks. With your pencil, mark through the back holes of the bracket. This is where your screws will go.

3. At each of your marks, pre-drill holes with a 5/64" drill bit. Align each bracket with your screw holes and drill the screws securely into place.

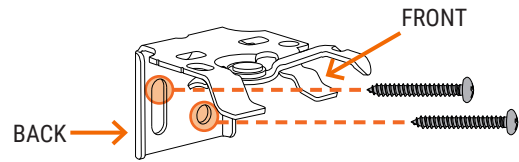
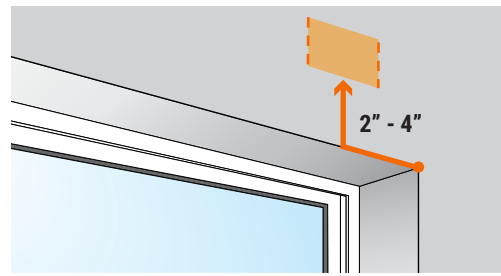

2. ATTACHING THE SHADE

INSIDE AND OUTSIDE MOUNT

1. Slide the swing-arm of all the brackets to the right, so that they point away from the window.

2. Place the headrail onto the brackets so that the front edge of the brackets fit under the inner front lip of the headrail. Slide the headrail left and right until the shade is centered in or over the window.

3. Hold the shade in position, and slide the swing-arms to the left on all the brackets, until they latch onto the back lip of the headrail. The shade is now installed!

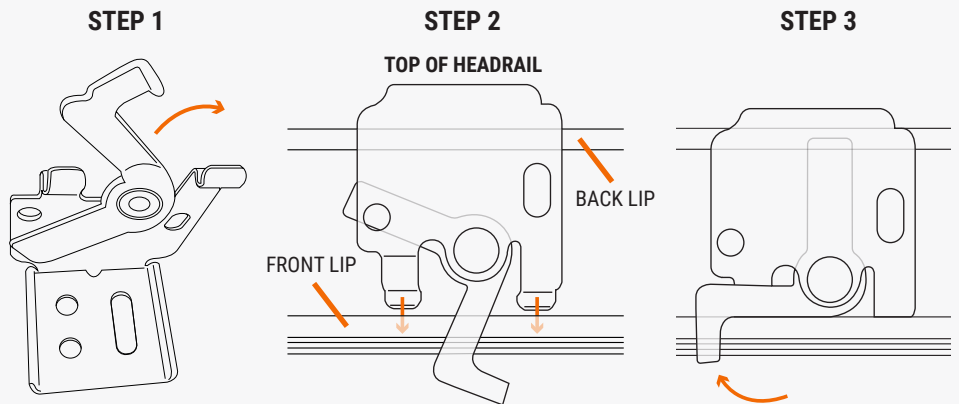

3. HOW TO USE YOUR SHADE

NOTE: Cordless roman shades come with one or two clear plastic handles to keep the fabric clean over multiple uses.

1. At the bottom pleat of the roman shade, locate the sewn-in hem bar. Snap the handle to the center if you only have one, or space them evenly if you have two.

2. To lower the shade, grip the handle(s) and slowly pull straight down.

3. To raise the shade, place your hand on the handle(s) with your palm facing up. Pull the bottom pleat slightly away from the window and then SLOWLY lift the shade. The pleats should fold like an accordion as you raise the shade.

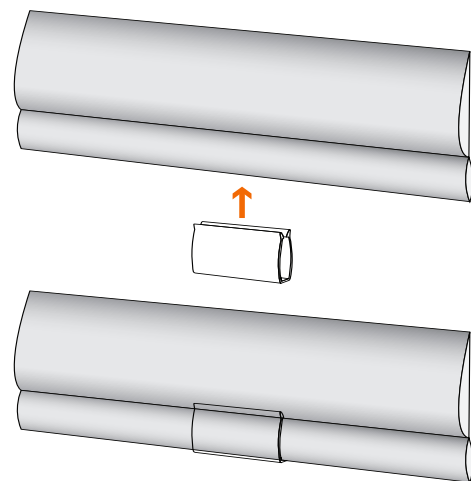

ROMAN SHADES

LIFT SYSTEMS: STANDARD LIFT | TOP DOWN BOTTOM UP | CONTINUOUS CORD LOOP | MOTORIZATION



The difficulty level of this installation is ranked at **Level 2**. You got this!

If you have questions or get stuck, call our Customer Care Team at 888-685-1735, or email info@selectblindscanada.ca

HARDWARE AND PARTS INCLUDED

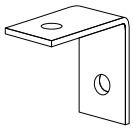

BRACKET*
(STANDARD LIFT)

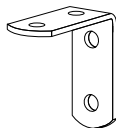

BRACKET*
(ALL OTHER LIFTS)

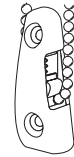

CHAIN
TENSIONER



TENSIONER
BRACKET



CORD CLEAT

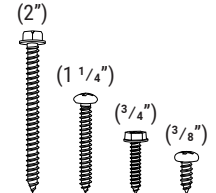

INSTALLATION SCREWS

* The quantity of brackets you receive will depend on the width of your roman shade.

TOOLS REQUIRED



PENCIL



TAPE MEASURE

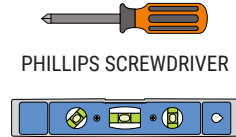

PHILLIPS SCREWDRIVER

LEVEL



5/64" DRILL BIT



PHILLIPS DRILL BIT



1/4" NUT DRIVER BIT



POWER DRILL



STEP LADDER

1. MOUNTING THE SHADE

INSIDE MOUNT

NOTE: There are no brackets used for inside mount. Use the pre-drilled holes in the top of the headrail as a guide for your screw placement.

1. Grab the headrail, and hold it up inside the top of the window. Set it back until the front of the shade is flush with the wall, and make sure it's centered. While holding the shade material above the headrail, mark through each hole with your pencil.

2. Pre-drill holes at each mark with a 5/64" drill bit, then use the 2" installation screws to mount the headrail directly to the top of the window.

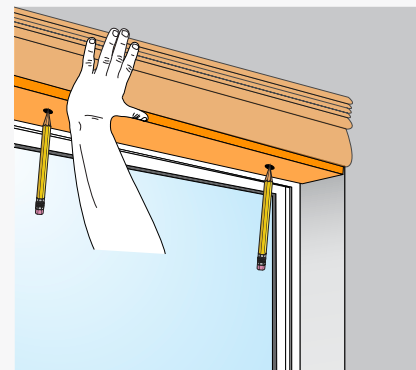

OUTSIDE MOUNT

NOTE: Use the pre-drilled holes in the top of the headrail as a guide for your bracket placement. Depending on the size and weight of your shade, you may need an extra set of hands to help you.

1. Center and hold the headrail at least two inches above the window. While keeping the shade level, make a small line with your pencil just above each of the pre-drilled holes in the headrail. Set the shade aside.

2. Align the top edge of a bracket along each mark, and use the holes in the back of the bracket to mark where your two screws will go.

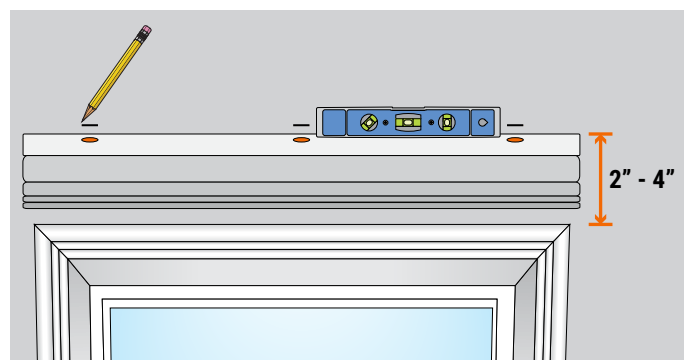

3. Pre-drill the screw holes for each bracket with a 5/64" drill bit. Align the brackets with the holes, and use a Phillips drill bit to fasten the 1 1/4" screws into place.

4. Rest the bottom of the headrail on top of the brackets so that the holes align. Use your drill to insert the 3/4" screws into the pre-drilled holes of the headrail.

5. That's it! With the shade now secure, follow any additional steps necessary to complete your installation.

A. **Standard Lift:** Install at least one cord cleat to safely tuck away loose strings (page 4).

B. **Continuous Cord Loop:** Install the chain tensioner that came attached to the chain (page 4 - 5).

C. **Top Down Bottom Up:** Install a cord cleat on the left and right to safely tuck away loose cords (page 4).

D. **Motorization:** Program your remote and motor (page 5 - 8).

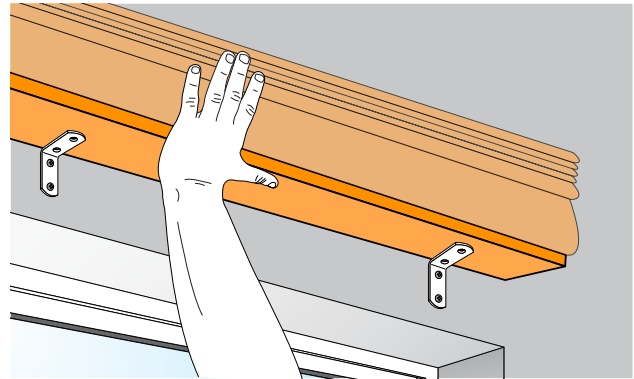
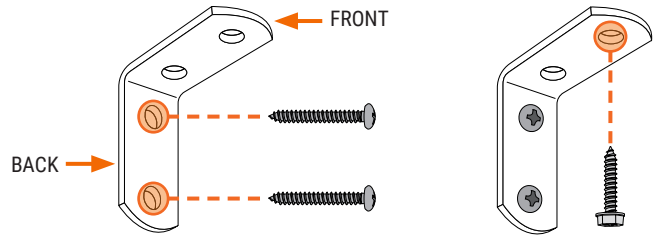

2. ADDITIONAL INSTRUCTIONS

To complete your installation, follow the instructions below that match with the lift style you have.

INSTALLING CORD CLEATS

STANDARD CORDS AND TOP DOWN BOTTOM UP

NOTE: Shades with cords present a strangulation risk for young children and pets. Cord cleats are included as an important safety feature. Please follow the steps below to properly install them. If you need extra cord cleats, call our Customer Care team and we'll send them to you for free.

1. Place the cord cleat inside, or next to the window frame, so it's well out of reach of small hands and paws (typically 4'-5' above the floor). For inside mount, be sure the cleat is set behind the fabric, close to the window.
2. Use your pencil to mark through the holes in the cord cleat. You can pre-drill a hole with a 5/64" drill bit to make the screw easier to install, if you prefer.
3. Align the hole in the cord cleat with your mark and attach with screw provided. Do NOT over-tighten the screw!
4. With the cord cleat attached, you may now safely tuck the cords away after each use of the shade.

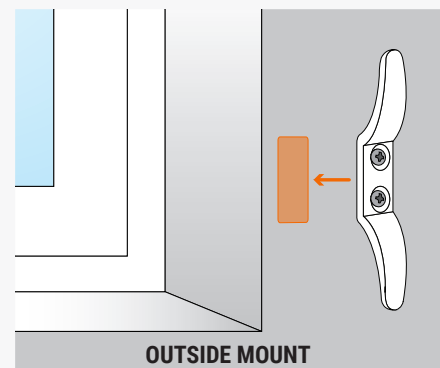
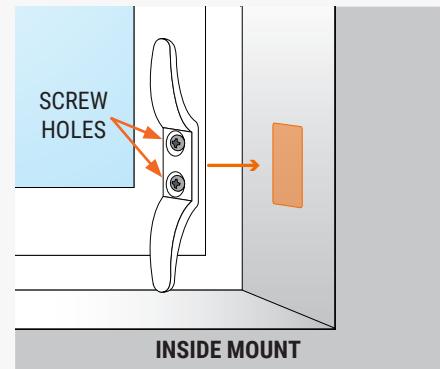

INSTALLING CHAIN TENSIONER

CONTINUOUS CORD LOOP

NOTE: Cord or chain tensioners are used to ensure the smooth operation of your shade and to help protect children from getting tangled in loose chains. If there is any protective plastic around the chain, remove it before you proceed.

CHAIN TENSIONER

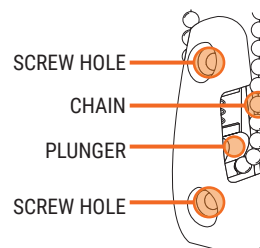

TENSIONER BRACKET

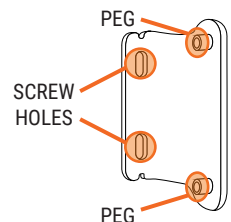

1. Raise the shade fully so it's out of the way.
2. Hold the tensioner in one hand and with your other hand, pull the plunger up to release the grip on the chain. Lift the chain out of the bead-locking groove and slide the tensioner to the bottom of the loop.
3. The goal of using the tensioner is to make the chain taut but still slightly loose. For inside mount, you will not need the tensioner bracket.

INSIDE MOUNT

- A. Place the tensioner against the inside of the window and keep the chain pulled tightly. Shift it up about 1/8", then make a mark at each screw hole.
- B. Move the chain away and use the marks to pre-drill screw holes with a 5/64" drill bit.
- C. Align the tensioner with the pre-drilled holes and fasten the 1 1/4" screws, being careful NOT to over-tighten the screws.

OUTSIDE MOUNT

- A. Connect the tensioner to the pegs on the tensioner bracket. Place the tensioner bracket against the wall while keeping the chain pulled tightly. Shift it up about 1/8", then make a mark at each screw hole.
 - B. Move the chain away and use the marks to pre-drill screw holes with a 5/64" drill bit.
 - C. Remove the tensioner bracket from the tensioner, align the tensioner bracket with the holes and fasten the 1 1/4" screws, being careful NOT to over-tighten the screws.
 - D. Re-attach the tensioner to the pegs of the tensioner bracket, and fasten the 3/8" screws, being careful NOT to over-tighten the screws.
4. To use your shade, simply pull the front of the chain to raise it, and pull the back of the chain to lower it.

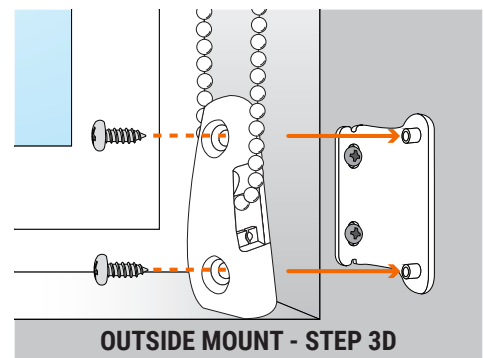
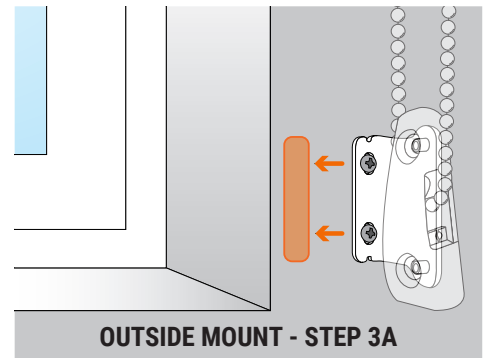
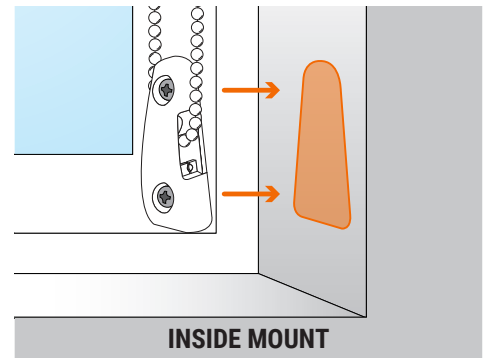

3. PROGRAMMING AND USING YOUR REMOTE

WARNING: DO NOT attempt to raise or lower your motorized shade with your hands. This may cause permanent damage to the motor, and other components in the headrail, which may not be covered under your warranty.

OPERATIONAL FUNCTIONS

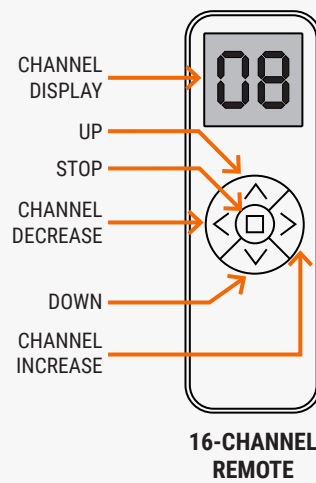
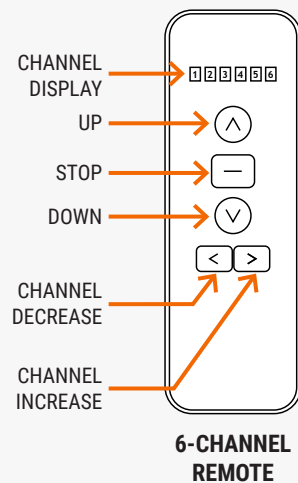
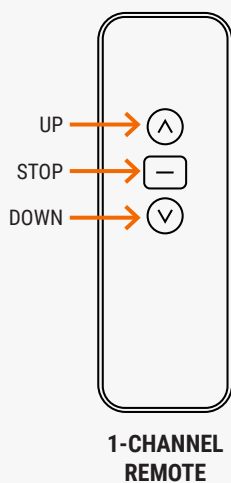

PROGRAMMING FUNCTIONS

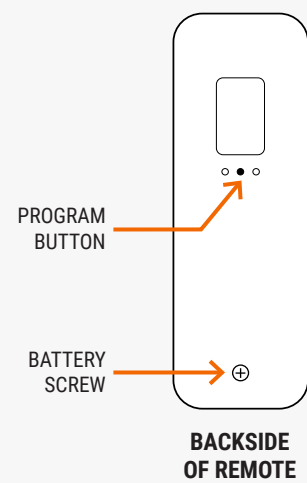

PAIRING A SINGLE SHADE TO A CHANNEL

1. Press the **CHANNEL INCREASE** or **CHANNEL DECREASE** button on the remote to select a dedicated channel for the first shade you're pairing with the remote.

2. Locate the **MOTOR HEAD** on the left end of the roller tube under the headrail. Press and hold the **PROGRAM** button until you hear a beep and the shade "jogs" quickly up and down.

3. Press the **UP** button on the remote and the shade will jog again.

4. Congrats! Your shade and remote are now paired. Repeat this process for any additional shades you want to pair with the remote, selecting a new channel (if using a multi-channel remote) before you begin.

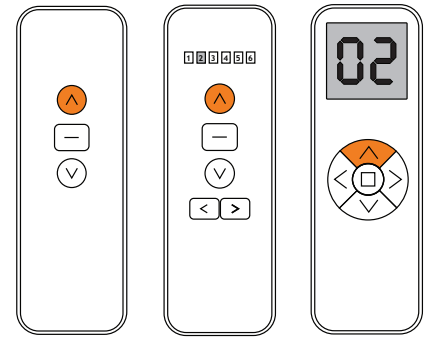
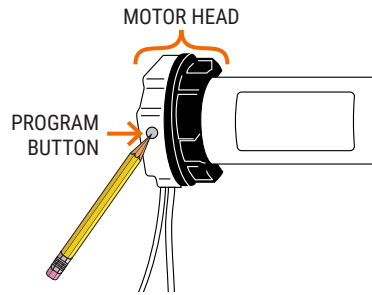

PAIRING MULTIPLE SHADES TO ONE CHANNEL

NOTE: You must have at least one shade already paired to a channel, before following the steps below.

1. Put the shade on your selected channel into "sleep" mode. To do this, press and hold the **PROGRAM** button on the **MOTOR HEAD** until the shade jogs and you hear a long beep. Release the button to put it to sleep.

2. Follow the steps above for "Pairing a Single Shade to a Channel" to pair a new shade while remaining on the same channel. When you've finished, put this shade to "sleep" as described in step 1.

3. Repeat step 2 for any additional shades you wish to add to the channel. Once you've paired all the shades you want, "wake up" each shade's motor by pressing and holding the **PROGRAM** button on the **MOTOR HEAD** until you hear a short beep.

4. That's it! You can now simultaneously operate all the shades paired with this channel.

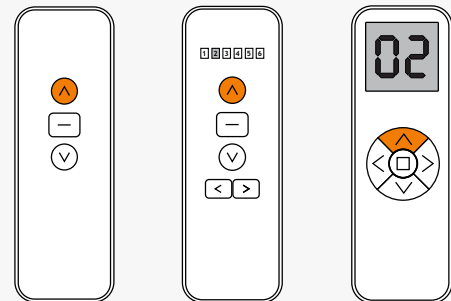

ADJUSTING THE UPPER/LOWER LIMITS

Your shade's upper and lower limits are already pre-set at the factory, so the following steps are only necessary if you want to change how these settings are configured. The upper limit can **ONLY** be changed after performing a factory reset (see page 7).

CHANGING THE UPPER LIMIT

NOTE: Prior to resetting the upper limit, you must first follow the instructions for performing a factory reset. This is the only way to change the upper limit.

1. Move the shade using the **UP** or **DOWN** buttons, until it is positioned about 6" below the desired upper limit.

2. Press the **PROGRAM** button on the back of the remote. The shade will jog, indicating it's now in programming mode.

3. Press the **UP** button to move the shade to the desired upper limit. Press the **PROGRAM** button on the back of the remote again and the shade will jog.

4. That's it! You've now reset your shade's upper limit, and the motor will exit programming mode automatically.

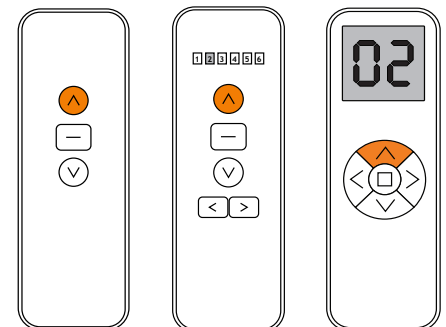
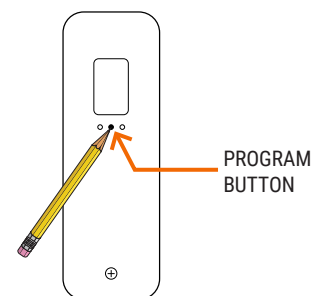

CHANGING THE LOWER LIMIT

1. Move the shade using the **UP** or **DOWN** buttons, until it is positioned about 6" above the desired lower limit.
2. Press the **PROGRAM** button on the back of the remote. The shade will jog, indicating it's now in programming mode.
3. Press the **DOWN** button to move the shade to the desired lower limit. Press **PROGRAM** on the back of the remote again and the shade will jog.
4. That's it! The lower limit is set, and the motor will exit programming mode automatically.

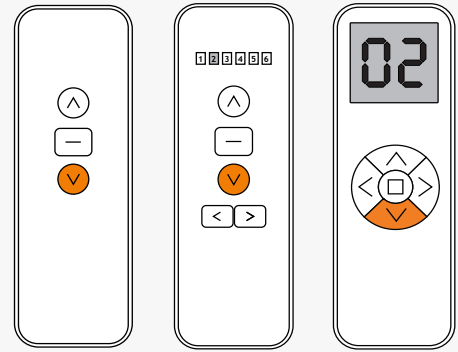

SETTING INTERMEDIATE POSITIONS

NOTE: You can set up to four (4) intermediate positions between the shade's upper and lower limits. Each intermediate position must be at least 6" away from the upper and lower limits, and any other intermediate limits you program.

1. Move the shade using the **UP** or **DOWN** buttons until it's at least 6" away from any other limits.
2. Press the **PROGRAM** button on the back of the remote. The shade will jog, indicating it's now in programming mode.
3. Use the **UP** or **DOWN** button to move the shade to the desired stopping position and press the **PROGRAM** button again. The shade will jog, indicating the new stopping point is now set.
4. Repeat these steps to add up to four intermediate stopping points to your shade.

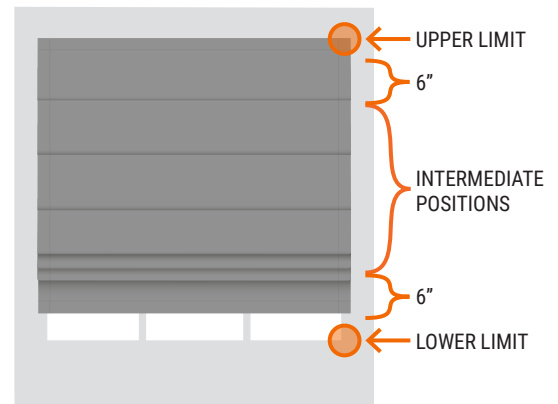

DELETING LOWER LIMITS AND INTERMEDIATE POSITIONS

NOTE: Lower limits and intermediate positions can be deleted and reassigned. Upper limits can only be removed by performing a factory reset.

1. To delete a specific shade position, use the **UP** or **DOWN** buttons to move the shade to the position you want to remove.
2. Press and hold the **PROGRAM** button on the back of the remote for about 7 seconds. The shade will jog once before the 7 seconds and once after. You have now deleted the limit/position from your shade.

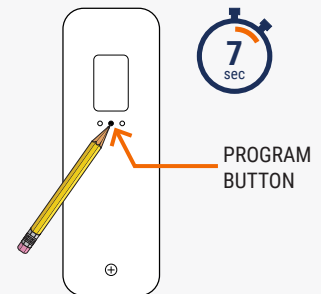

PERFORMING A FACTORY RESET

1. Press the **PROGRAM** button on the **MOTOR HEAD** four (4) times in a row.
2. Press it again for a fifth time, holding the button down until the shade jogs twice.
3. Your shade's memory and all presets have now been erased. To use the shade again, pair a remote to it and then set new upper/lower limits.

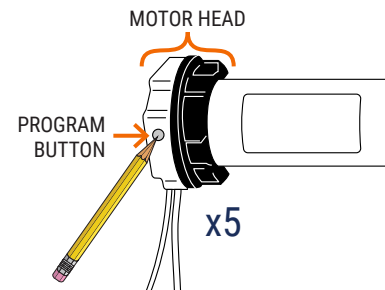

USING THE REMOTE TO CONTROL YOUR SHADE

1. Press the **UP** or **DOWN** button once to move the shade to the next higher or lower position.
2. Press the **UP** or **DOWN** button two times (once per second) and the shade will move to the upper or lower limit position without stopping at any intermediate positions you may have set.

RECHARGING THE SHADE BATTERY

NOTE: If the shade begins to move at a slower pace, the battery charge may be getting low. Plug the shade into a power outlet and charge the battery for 6 hours.

1. Locate the charger cable behind the fabric on the left side of the headrail. Connect this cable to the provided battery charger.
2. Plug the battery charger into the nearest wall outlet. If the cable isn't long enough to reach an outlet, use an extension cord (not included) to bridge the gap.

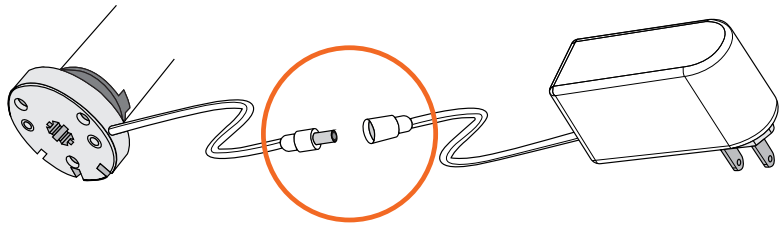

REPLACING THE REMOTE BATTERY

NOTE: The battery used to power your remote is a coin-shaped 3V cell battery (CR2032). Additional batteries are not included.

1. To remove the back cover of the remote, use a small screwdriver to remove the battery screw. Gently slide the back cover up to disengage it, then lift it away from the remote.
2. Remove the old battery from the circuit board by sliding it diagonally out of the bracket holding it down. Place a new 3V cell battery in the bracket with the "+" positive side showing.
3. Replace the back cover of the remote, and secure the battery screw.

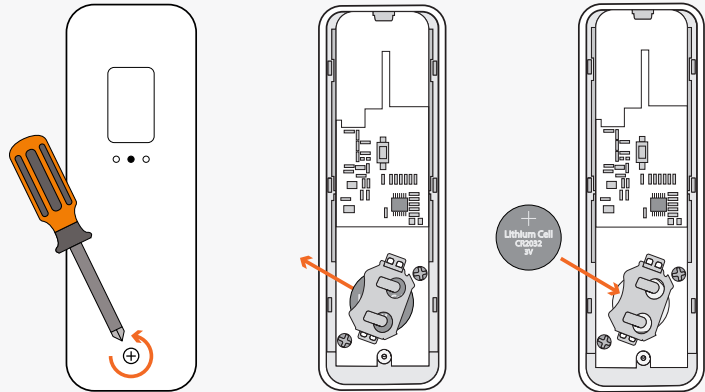

INSTALLING A WALL MOUNT CARRIER

NOTE: A wall mount carrier is included with your remote, but it is optional to install it. If you choose to mount the carrier with the adhesive patch on the back, be sure to clean and dry the mounting surface first.

1. Determine where you'd like to place your remote carrier in the room. It is common to place it near a light switch, or on the wall next to the window.
2. With the carrier in the upright position, insert the provided screws to secure it to our mounting surface. For the adhesive patch, firmly press the carrier to the surface for about 30 - 45 seconds.

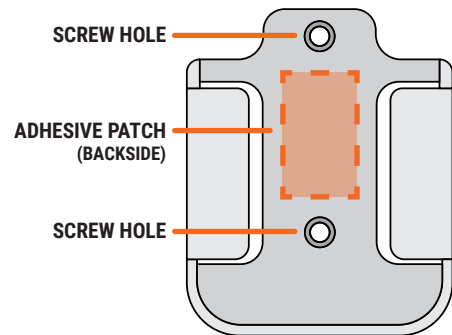

CLEANING INSTRUCTIONS

NOTE: All fabrics are different and some may be easier to clean than others. We recommend cleaning your shades as often as once a month. Here are some general guidelines on how to do so:

1. For regular maintenance, use a duster or a vacuum with a brush attachment and run it over the front and back of the shade.
2. To spot clean stains, use a damp rag with a very mild, gentle detergent or soap. Dab at the affected spots; do NOT rub! Let the dampened area air-dry and repeat as necessary.
3. If your roman shade has wrinkles, you can use a basic steamer to remove them. Hold the steamer roughly six inches away from the fabric and wave the steamer back and forth over the wrinkled areas.

WARRANTY AND REPLACEMENT

To learn more about our product warranties, please visit: <https://www.selectblindscanada.ca/warranty>

For replacement parts, and/or to file a warranty claim for a product that is damaged, defective, or missing parts, please call our Customer Care Team at 888-685-1735, or email info@selectblindscanada.ca

CHILD SAFETY WARNING

⚠ WARNING

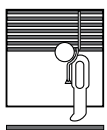

Corded window blinds and shades can be a strangulation risk or cause serious injury to young children and pets. When using corded window treatments, use the following tips to keep them safe:

- Move furniture that children can climb on away from the window.
- **NEVER** place a crib by a window!
- Keep cords up and away from your child's reach.
- Always use cord cleats with corded products.
- Secure child-safe tensioners for continuous cord loop chains to the wall or window encasement.

Smart WiFi Hub Instructions

1. Download & Install "P2 POWERMATE" APP on your cellphone

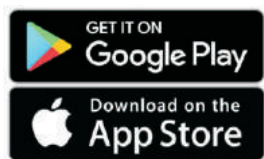

powermate smart hub



powermate

powermate APP

- (1) Search for "P2 POWERMATE" on the App Store or Google play
- (2) Download "P2 POWERMATE" and install the APP on your phone

2. Register and login to the P2 POWERMATE APP

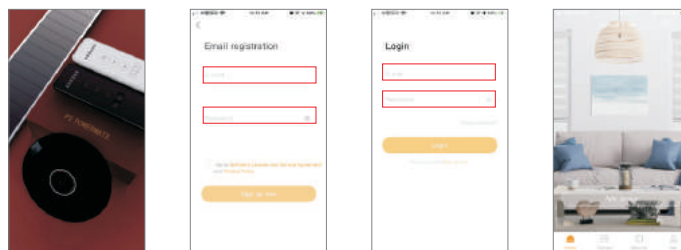

- (1) When installation is complete open P2 POWERMATE
- (2) Create an account using your e-mail address – enter a password that should include letters and numbers only, no signs or special characters
- (3) Login in to your account (after the account is established you will login to the APP directly)

3. Link the P2 POWERMATE hub to the POWERMATE APP

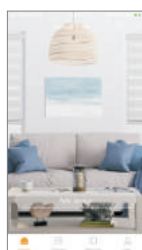

- (1) Choose "Add device" on desktop

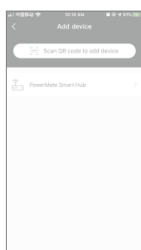

- (2) Choose P2 POWERMATE Smart Hub



- (3) Choose "Allone Pro"



- (4) Power on the P2 POWERMATE hub



- (5) Press and hold the central button on the hub until the circular light turns RED and Flashes



- (6) Choose "Next" on the P2 POWERMATE APP



- (7) Choose "Join" to enable the hub to access your Wi-Fi network
Tip: Make sure your network is available, not restricted to assure access



- (8) Select your Wi-Fi network and input your Wi-Fi password



- (9) The P2 POWERMATE hub will connect to your Wi-Fi network automatically. When you see "Added successfully" on the P2 POWERMATE APP, choose "Done"

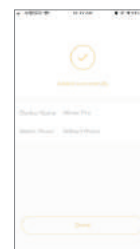

- (10) The APP is linked to the P2 POWERMATE hub when Allone Pro appears on the desktop

4. Add your shades to the P2 POWERMATE APP

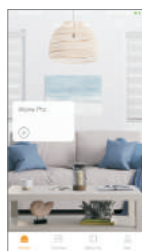

- (1) Choose "Allone Pro" on the APP desktop

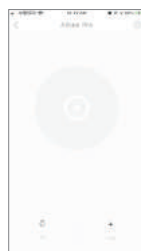

- (2) Choose "+ Add" at the menu bottom right corner

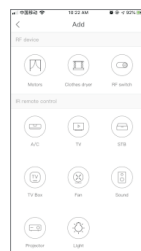

- (3) Choose "Motor" device

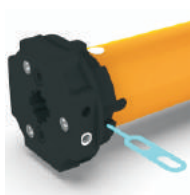

- (4) Now press the "programming button" on motor head for 1 second - the shade will oscillate one time. Then tap "pairing" on P2 POWERMATE APP. If the shade is successfully added to the APP, the shade will oscillate one more time.
If not, repeat the step 4 operation.



- (5) Choose "Response has been stored" when the shade is successfully added to APP.



- (6) The shade has been added to the P2 POWERMATE APP. Confirm that you can now control the shade using the APP, and then proceed to add additional shades if applicable.

5. Family “Member Permission” management

Note that the set-up account is the one and only administrator – only the administrator's login can make changes to the APP. However, the administration account can add family members with their own ID, and they can then control the shades from their phones or tablets.

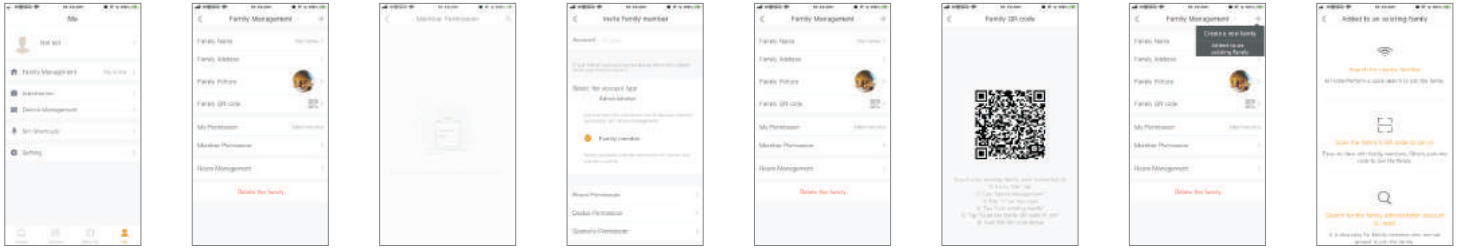

(1) Choose “Me” on the P2 POWERMATE desktop, and then Select “family Management” menu

(2) Choose “Member Permission”

(3) Tap “+” family members at the top right corner of the screen

(4) Input your family “Account e-mail address” then go to invitation to your family member

(5) When your family member receives and accepts the invitation, the Administration account shows the family QR Code that the family member will scan. The family member taps “+” at the top right corner, and chooses “Add to an existing family”. Choose “scan the family’s QR code to join it”, and then scan the code on the administrators screen.

6. “Siri Shortcut” Voice Command Management

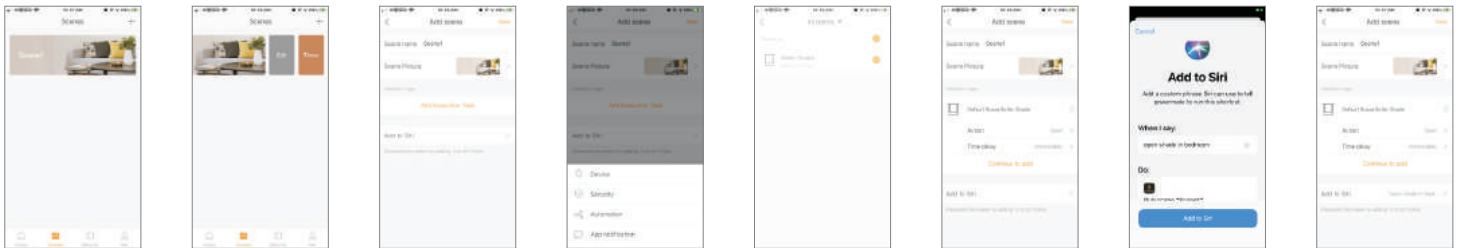

(1) Choose “Scenes” on the P2 POWERMATE desktop. Create a scene.

(2) Slide the “scene” icon to left, and then choose “Edit” scene

(3) Add Execution Task

(4) Choose “Device” and then select the shade you want to add to this scene

(5) Choose an “Action” for the shade you selected. Then Add to Siri.

(6) In the Add to Siri menu, you can edit the “Siri shortcut command”. For example: “open shade in bedroom”. After all tasks are set up, save the scene. Now you can let Siri control your shades.

7. Link to “Amazon Alexa” & “Google home” voice control device

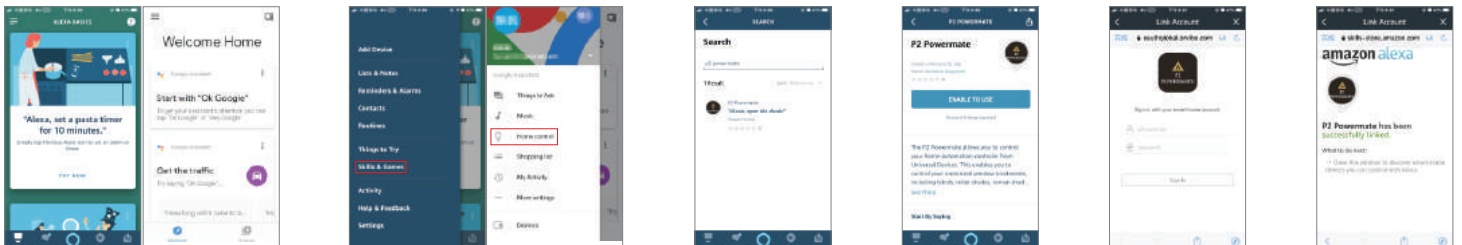

(1) Login in your “Amazon Alexa” or “Google home” APP

(2) “Amazon Alexa” add “Skills & Games” “Google Home” add “Home control”

(3) Search “p2 powermate”

(4) Choose “ENABLE TO USE”

(5) Input your “p2 powermate” account and password, then sign in. Now P2 Powermate had been linked to your “Alexa” or “Google Home” voice control device.

Motorization Troubleshooting Guide

PROBLEM	SOLUTION
Shade moving in the wrong direction.	Reset the motor to factory spec and erase all limits, then program from the beginning.
Shade not stopping at desired height (reset limit).	Top limit can not be reset without erasing all limits and starting from the beginning. Take the shade to the incorrect limit, press and hold the program button on the back of the remote until the shade jogs. Move the shade to the desired height, then press and hold the program button until the shade jogs again. The limit has been reset
Motor has no response to remote.	Press and hold the program button on head of motor. See if it jogs. If it does, then walk through programming from beginning, Check the antenna, make sure it is not kinked or touching metal.
Still not working. Plug in the motor.	See if motor operates or can be programmed.
Switch motor to another channel.	If remote already has 1 motor on the desired channel, put that motor in sleep mode and then erase the memory of the motor that is to be switched and joined on another channel. Program the new channel and then wake the other motor up.
Motor begins to beep. Power is getting low.	Plug in the motor as soon as possible. If the power drops to zero voltage, the memory could be lost and the motor will have to be reprogrammed.