

Locating the brackets

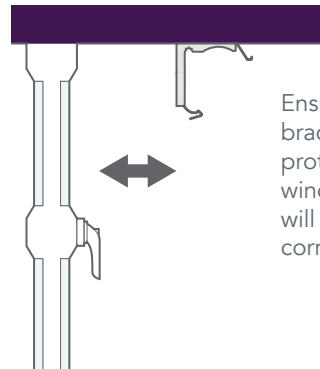

The position that you place the outermost brackets must be 5cm away from the end of the rail. Any additional brackets (supplied for wider blinds) can then be evenly distributed across the window space. Use a pencil to mark the window area where the brackets will be positioned.



Ensure that the back of the bracket sits clear of any protruding items such as window handles or vents. This will allow the blind to hang correctly once installed.

Fitting the brackets

1

The brackets offer two methods of installation:

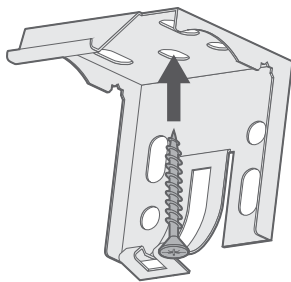

Top-Fixing

Use the single hole in the top of the bracket to fix to the lintel (the 'ceiling' of the recess).

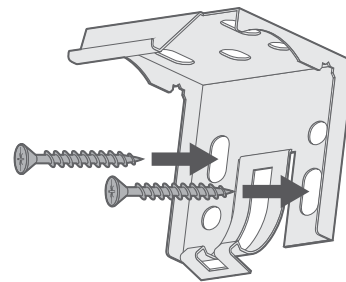

Face-Fixing

Use two screws through the back plate to mount onto a facing surface (a wall or window frame)

Fitting the blind

2

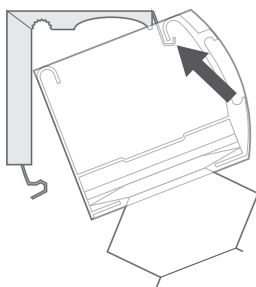

Situate the front lip of the headrail into the front hook of the bracket.

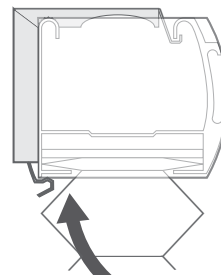

Push the back of the headrail upwards to engage the metal clip at the back of the bracket.

Additional Information

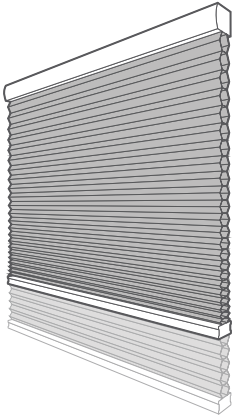

If the blind appears too short when fitted, don't worry, it can take some time for the pleats to settle and loosen up when the blind is new. Leave the blind lowered for 24 hours and you should find that it begins to settle quite quickly. If you want to help it along, you can simply pull the blind down to its fullest extent and brush your hand vigorously down the pleats from top to bottom. **Do not attempt to adjust the cords.**

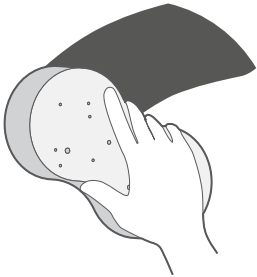

Cleaning the blind is easy; keep it free of dust using the brush attachment of a vacuum cleaner, and clean any marks or stains using a damp cloth or sponge. **Do not soak the blind fabric as this can cause the pleats to lose their shape.**

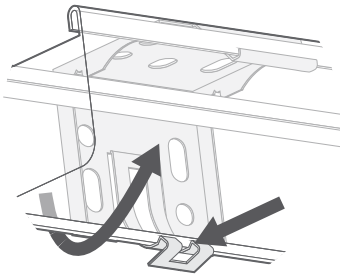

To remove the blind from the brackets, insert a flat head screwdriver into the tab protruding from the bottom of the rail, then gently pry it back while tilting the back of the rail downwards. Repeat this carefully for each bracket to release the rail.

WARNING

STRANGULATION HAZARD — Young children can be strangled by cords. Immediately remove this product if a cord longer than 22 cm or a loop exceeding 44 cm around becomes accessible.

BUILT-IN NO DRILL CELLULAR SHADE

LIFT SYSTEMS: CORDLESS LIFT



The difficulty level of this installation is ranked at **Level 2 - You got it!**

If you have questions or get stuck, call our Customer Care Team at 888-685-1735, or email infor@selectblindscanada.ca

ATTACHING THE SHADE

1. To install the built-in no drill headrail honeycomb shades, open the fabric on the right side of the headrail to locate the level.

NOTE: Ensure the inside mount depth of your window frame is at least 2" required.



2. Hold the Headrail up against the top of the window opening and make it flush.

NOTE: Ensure that the lever is loose and the cover pad at least align with the edge of the window opening.

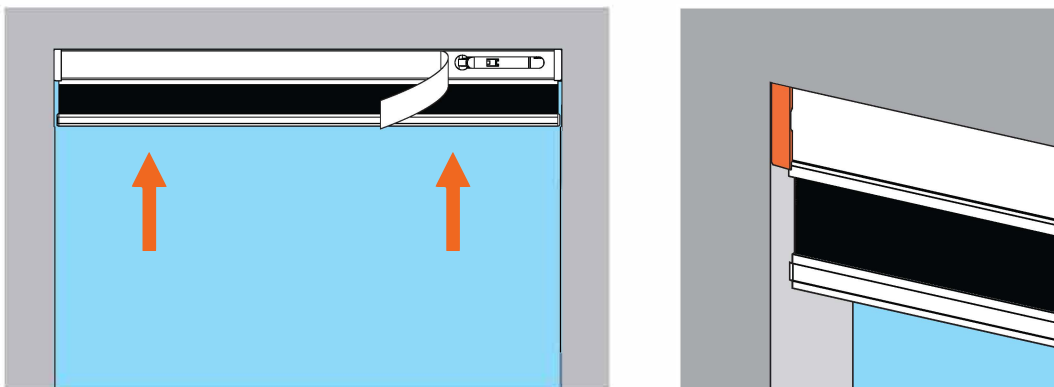

3. Hold the blind in position then push the lever firmly upwards until the rail snaps into place.

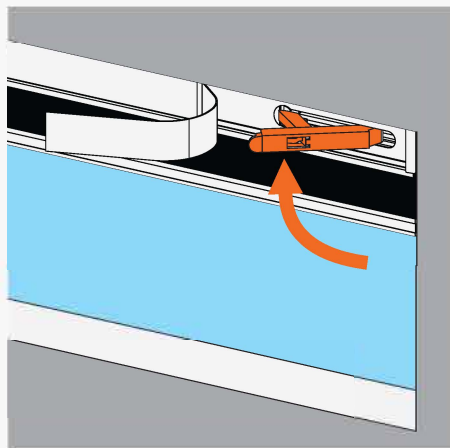

4. Once you have ensured that the installation is complete and the shades are properly aligned, carefully insert the fabric back into the headrail. It is important to check the edges to ensure that they fit securely inside and adequately cover the lever. This will ensure optimal functionality and a polished appearance for your shades.

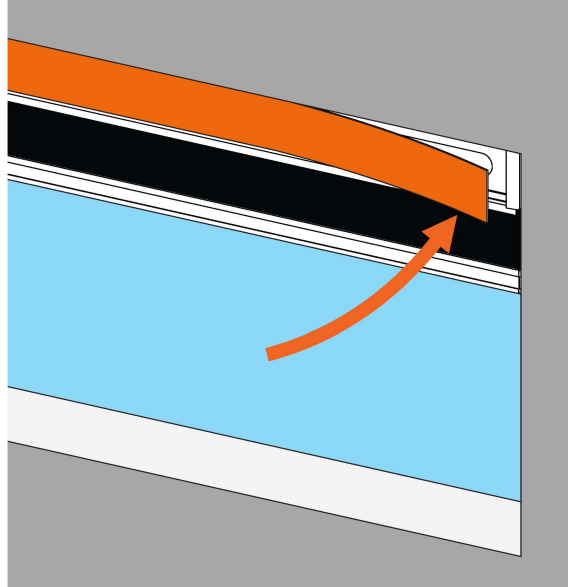

CLEANING INSTRUCTIONS

NOTE: All fabrics are different and some may be easier to clean than others. We recommend cleaning your shades as often as once a month. Here are some general guidelines on how to do so:

1. For regular maintenance, use a duster or a vacuum with a brush attachment and run it over the front and back of the shade.
2. To spot clean stains, use a damp rag with a very mild, gentle detergent or soap. Dab at the affected spots; do **NOT** rub! Let the dampened area air-dry and repeat as necessary.

WARRANTY AND REPLACEMENT

To learn more about our product warranties, please visit: <https://www.selectblindscanada.ca/warranty>

For replacement parts, and/or to file a warranty claim for a product that is damaged, defective, or missing parts, please call our Customer Care Team at 888-686-1735, or email infor@selectblindscanada.ca.

WARNING

STRANGULATION HAZARD - Young children can be strangled by cords. Immediately remove this product if a cord longer than 22 cm or a loop exceeding 44cm around becomes accessible.