

SelectBlinds®

Cellular Shades

Installation Instructions for Deluxe Headrail

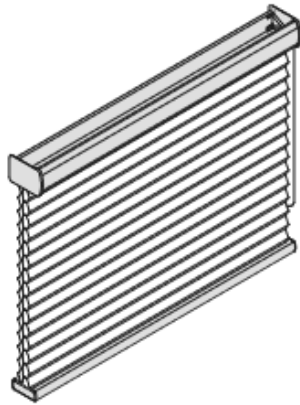

Cellular and Pleated Shades are designed to provide years of reliable service when properly installed. Please take a few minutes to read through these instructions before beginning.

1. Bracket Installation

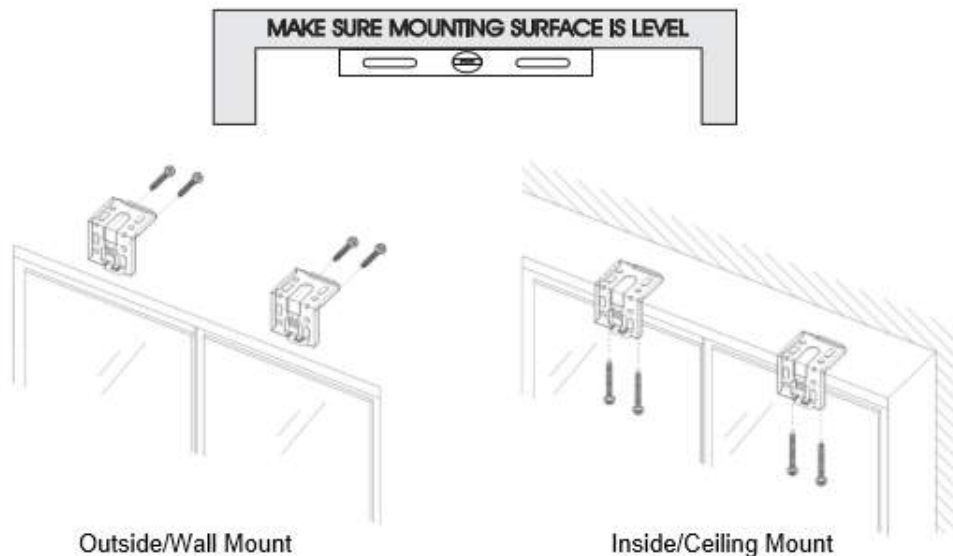

Install the brackets approximately 3" from either end of the headrail (drywall plugs if required, can be purchased from a local hardware store).

Depending on the width of the shade, additional brackets may be necessary and should be evenly spaced between the two end brackets. Ensure each bracket is level and in alignment with one another.

2. Mounting the Shade

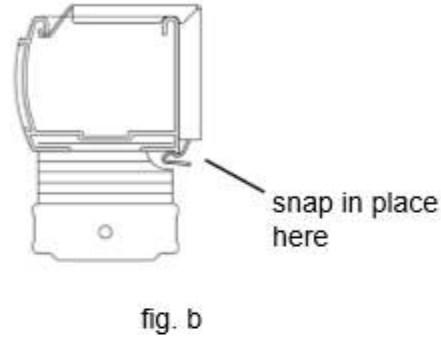
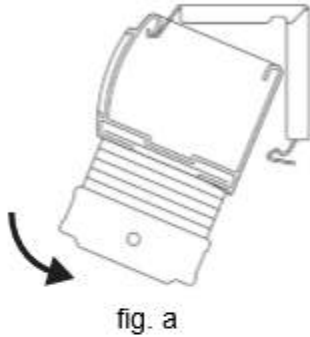

Hook the front of the headrail onto each bracket as shown in fig. a. Rotate the headrail back and snap the headrail into place (fig. b) on each bracket ensuring a tight and secure fit.

3. Removing the Shade

Insert a flat head screwdriver, between the bracket and headrail as shown (fig. c). Gently pry the spring clip of bracket off the headrail and unhook. The headrail should disengage from the bracket

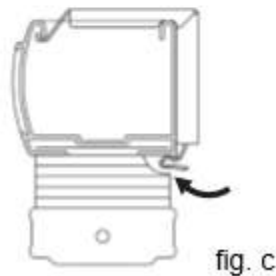

4. Cleaning and Child Safety



Light Vacuuming or dusting



No Solvents, chemicals, or abrasives



For child and pet safety please secure cords and chains with supplied tension device.

Remote User & Programming Guide

Your shades have been custom programmed by our factory to automatically stop at the top and bottom of your windows. Please consult this guide for proper shade operation and programming.

5 Channel Handheld Remote

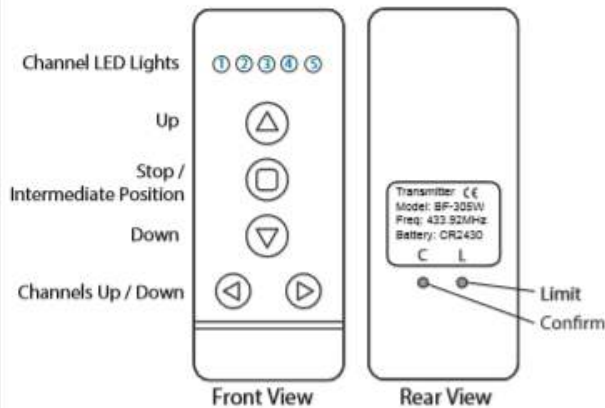

Operating Instructions

Raise Shade: Press and hold button for 1-2 seconds.

Lower Shade: Press and hold button for 1-2 seconds.

Stop Shade: Press button while shade is in motion.

Intermediate Position: Press button when shade is stopped (must be set by user, see pg. 2 for setup).

Tilt Shade (Zebra & Sheer Horizontal Shades only): Press and release or button.

Change Channels: Press or arrows to change channels. The numbered LED lights at the top of the remote indicate the current channel. When all LED lights are on, the remote will operate all shades.

5 Channel Wall Remote

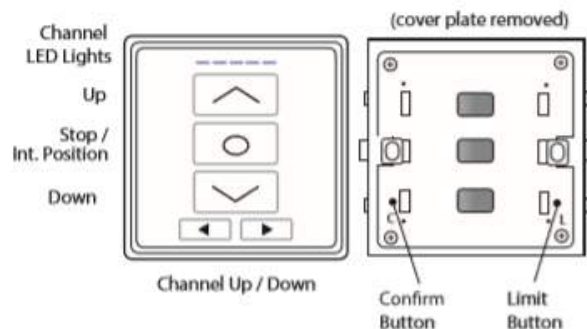

Operating Instructions

Raise Shade: Press and hold button for 1-2 seconds.

Lower Shade: Press and hold button for 1-2 seconds.

Stop Shade: Press button while shade is in motion.

Intermediate Position: Press button when shade is stopped (must be set by user, see pg. 2 for setup).

Tilt Shade (Zebra & Sheer Horizontal Shades only): Tap or button.

Change Channels: Press or arrows to change channels. The numbered LED lights at the top of the remote indicate the current channel. When all LED lights are on, the remote will operate all shades.

Pairing a New Motor to Your Handheld Remote or Wall Remote

- 1) **Press and hold** the red button on motor for 1-2 seconds until the shade jogs.
- 2) Select the desired channel to which you want to program the motor.
- 3) Using a pen or paperclip, gently press the confirm button marked "C" on the remote. The shade will jog to confirm successful programming.

Operating Shades as Group: By default, when all LED lights on your remote are on, it will control ALL shades within range. If you wish to create your own group on another channel, simply repeat steps 1-3 for additional motors but pair the motors to the same channel.

Removing a Motor From Your Handheld Remote or Wall Remote

(Don't worry, this will not erase the motor's limit positions)

- 1) **Press and hold** the red button on the motor for 4-5 seconds (motor will cycle through two distinct sets of jogs). The motor has now been removed from all paired channels on all remotes.

ATTENTION: Before attempting any of the programming functions in this section, **you must ensure the motor is NOT grouped on the same channel with any other motor(s).**

Follow these steps to isolate a grouped motor for individual programming:

- a) Disconnect the power from other motor(s) by either unplugging the battery wand(s) or DC transformer(s) **OR**
- b) Temporarily removing all other shades from the group channel (see section above for removing a motor).

Reverse Motor Rotation Direction

- 1) Press and hold the "Limit" and "Stop" buttons simultaneously until the motor jogs.

Setting New Upper and Lower Limits

- 1) Select the channel of the shade you want to adjust.
- 2) Press and **hold** the Limit button marked "L" on your remote for 5-6 seconds until the motor jogs.
- 3) Press "down" button to send shade down. **WARNING: ⚠️ MOTOR WILL NOT STOP ON ITS OWN!**
- 4) Press "stop" button once the shade reaches desired position at the window sill. Once stopped, the shade can be finely adjusted in small increments by pressing "up" or "down" buttons.
- 5) When satisfied, use a pen or paperclip to press "Confirm" to set the lower limit stop position. **CONTINUE TO STEP 6.**
- 6) Press "up" button to send shade up. **WARNING: ⚠️ MOTOR WILL NOT STOP ON ITS OWN!**
- 7) Press "stop" button when shade is **2" - 3" from top to prevent damage to the shade.** Once stopped, shade can be finely adjusted in small increments by pressing "up" or "down" buttons.
- 8) When satisfied, use a pen or paperclip to press "Confirm" to set the new upper limit stop position.

Setting A "Favourite" Intermediate Stop Position

- 1) Bring shade to desired intermediate stop position (i.e 50% height, window transom, latch etc).
- 2) Press and hold the "Limit" and "Up" buttons simultaneously until the motor jogs.

SETUP CODE CODE DE CONFIGURATION

N2421

Getting to know your Smart Controller

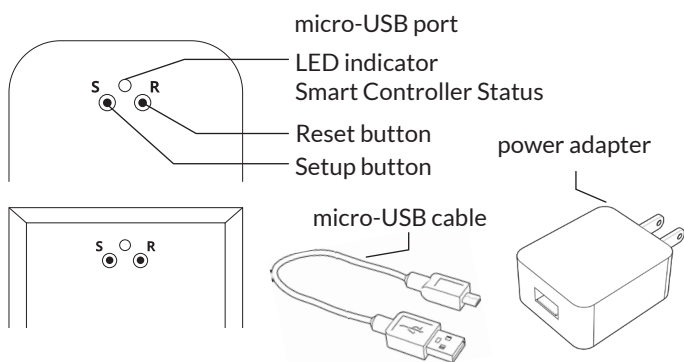

Smart Controller Status:
Flashing blue - Hotspot available
Flashing green - Connecting to the WiFi network
Pulsing cyan/blue-green - Connected to the Internet

Getting Started

- 1 Download the Neo Smart Blinds app**

Download the app to your phone or tablet by searching **Neo Smart Blinds** on Google Play or the App Store.
Note: Do not install Neo Smart Blinds Blue
- 2 Plug in your Smart Controller in reach of your home WiFi**

Choose a place not too far from your home router or a place you know has good WiFi signal strength. You will be able to change its location after, if necessary.
- 3 Create an account and choose the setup code written on the cover**

After opening the app, tap on Create one to create a new account. Enter a valid email address and choose a password, select the region time zone from the place where the Smart Controller will be located. Choose the setup code written in the cover and tap on Register.
- 4 Follow the app step by step to add the Smart Controller**

Have in hand the home WiFi password. It will be necessary to connect the Smart Controller to the Internet.
Note: Some Android users won't be connected quickly to the hotspot. If it is the case, please wait about 10 seconds before returning to the app. During this time, your device may notify you that the hotspot does not have Internet access, and will prompt you whether you want to remain connected. You need to select the option that will allow you to keep connected before returning to the app.

System requirements

- A strong WiFi signal (3 bars or more) in the location where you will setup your Smart Controller.
- The Smart Controller only supports 2.4GHz WiFi (IEEE 802.11b/g/n), not 5GHz. WiFi security needs to be set to WPA-PSK or WPA2-PSK.
- A smartphone or tablet running Android 5.0 (Lollipop) or higher, or iOS 8 or higher is needed.

Troubleshooting

The home WiFi doesn't appear in the step 4

Try rescanning, if the problem persists, you will need to reposition the Smart Controller to a place with stronger WiFi signal. In this case, exit the process (tap on the menu, then tap Your Rooms), replace the Smart Controller and start over.

The Smart Controller LED in the bottom is not blinking blue

The process fails in the last step

Press the S button for 10 seconds, then press the R button once and start over. Pay special attention when typing the WiFi password.

Need more help?

Visit neosmartblinds.com/smartcontroller for detailed instructions about how to use the app and troubleshooting.

Integrations

Smart home devices

Visit neosmartblinds.com/smartcontroller-integrations for detailed information about connecting to Amazon Alexa, Google Home and other systems.

Control4

Please send an email to tech@neosmartblinds.com with your name, your email and your company's name. This information is necessary to always send to you any further driver update.

Legal Information

FCC

This equipment has been tested and found to comply with the limits for a Class B digital device, pursuant to Part 15 of the FCC Rules. These limits are designed to provide reasonable protection against harmful interference in a residential installation. This equipment generates uses and can radiate radio frequency energy and, if not installed and used in accordance with the instructions, may cause harmful interference to radio communications. However, there is no guarantee that interference will not occur in a particular installation. If this equipment does cause harmful interference to radio or television reception, which can be determined by turning the equipment off and on, the user is encouraged to try to correct the interference by one of the following measures:

- Reorient or relocate the receiving antenna.
- Increase the separation between the equipment and receiver.
- Connect the equipment into an outlet on a circuit different from that to which the receiver is connected.
- Consult the dealer or an experienced radio/TV technician for help

Contains transmitter module FCC ID: COFWNMNB11

To comply with FCC/IC RF exposure limits for general population/uncontrolled exposure, the antenna(s) used for this transmitter must be installed to provide a separation distance of at least 20 cm from all persons and must not be co-located or operating in conjunction with any other antenna or transmitter.

IC

This device complies with Industry Canada's licence-exempt RSSs. Operation is subject to the following two conditions:

- This device may not cause interference; and
- This device must accept any interference, including interference that may cause undesired operation of the device.

This device meets the exemption from the routine evaluation limits in section 2.5 of RSS102 and users can obtain Canadian information on RF exposure and compliance.

Contains transmitter module IC: 10293A-WMNB11

This End equipment should be installed and operated with a minimum distance of 20 centimeters between the radiator and your body.

