

Cellular Shades

CORDLESS Lift & Lock

Standard and Top Down - Bottom Up



Installation & Care Instructions

152126H
5/14/2018

GETTING STARTED

A few simple tools are required:

- Measuring tape
- Power drill, drill bits
- 1/4" Hex head and/or Phillips driver bit
- Pencil

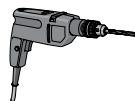

Additional fasteners other than those sent with your shade may be required depending on the mounting surface. Wallboard and plaster require the use of anchors such as expansion or toggle bolts. Brick, tile or stone need special plugs and drill bits. Remember to always pre-drill holes in wood to avoid splitting.

PN: CS707(std rail)
XCS707 (lg. rail)

PN: 20201012

PN: CS1000

PN: CS2000

PN: XCS1101

PN: CS1801(std rail)
XCS1801 (lg. rail)

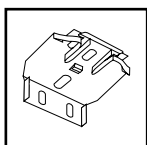

**Mounting
Bracket**



**1 1/4"
Hex Head
Bracket Screw**

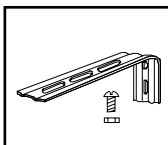

**Headrail
Extension
Bracket**

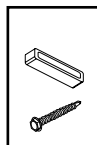

**Spacer
Block
(optional)**

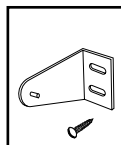

**Hold
Down Bracket
(optional)**

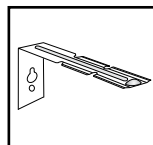

**Sidemount
Bracket (optional)**

STEP 1: BRACKET INSTALLATION

Shades are shipped with the required number of brackets for proper installation.

End brackets should be located approximately 1" from either end.

Depending on the width of the shade, additional brackets may be necessary, evenly spaced between the two end brackets.

Shade Width	# of Brackets
Up to 40"	2
>40" - 72"	3
>72" - 84"	4
>84" and up	5

Using the installation bracket as a template, measure to the edge of the bracket and mark the hole locations with a pencil for drilling.

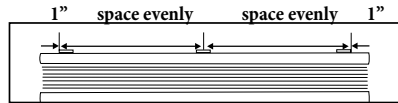

Brackets must be in line and level. Shim brackets on inside mounts if necessary. The headrail must be level for the shade to operate properly.

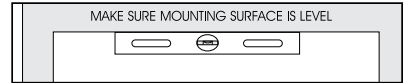

INSIDE MOUNT

The minimum mounting depth for an inside mount is $\frac{3}{4}$ ".

A minimum of 2" is needed to fully recess a shade with the standard rail. A minimum of 2 $\frac{1}{2}$ " is needed to fully recess a shade with the large rail.

Make sure that the brackets are level and aligned.

Attach using two screws.

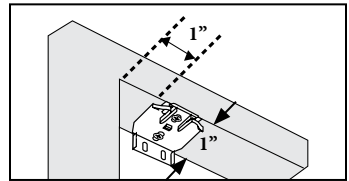

Inside Mount

Minimum $\frac{3}{4}$ " surface
Minimum 2 or 2 $\frac{1}{2}$ " surface for fully recessed (depends on rail size)

OUTSIDE MOUNT

The minimum mounting height for outside mounted shades is $\frac{3}{4}$ ".

Make sure that the brackets are level and aligned.

Attach using two screws.

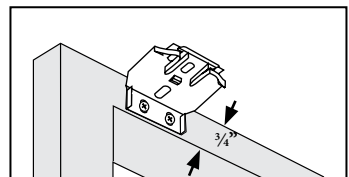

Outside Mount

Minimum $\frac{3}{4}$ " surface

SPACER BLOCKS (OPTIONAL)

Each spacer block projects brackets $\frac{3}{8}$ " away from mounting surface.

Make sure that the brackets are level and aligned.

Attach using two screws. Screws should be long enough to secure the bracket to the mounting surface.

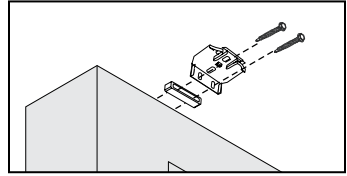

**Outside Mount
with Spacer Blocks**

EXTENSION BRACKETS (OPTIONAL)

Optional extension brackets are used to project the back of the shade up to $3\frac{3}{8}$ " from the mounting surface.

Attach the mounting bracket to the extension bracket with the nuts and bolts provided.

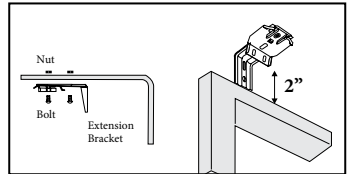

**Outside Mount
with Extension Brackets**
Minimum 2" surface

SIDE MOUNT

Line the bracket top with the desired height of the top of the head rail. Mark holes for screws (A). Remove brackets and drill holes.

Insert screws for keyhole slots only (B). Approximately $\frac{1}{8}$ " of the screw should be left protruding.

Pull the endcap out of the head rail and slide the bracket on as shown (C). Replace the endcap and then slide the bracket all the way into the head rail.

Install the second bracket in the same manner as the first bracket.

Hook one bracket onto the screw in the window frame, using the keyhole slot. Bring the other end bracket over the screw at the other side of the frame. Slide down, flexing bracket inward until the screw engages in the keyhole slot.

Make sure both brackets are slipped down all the way, so that the screw is in the top portion of the keyhole slot. Install a screw in the bottom hole of each bracket. Tighten all screws.

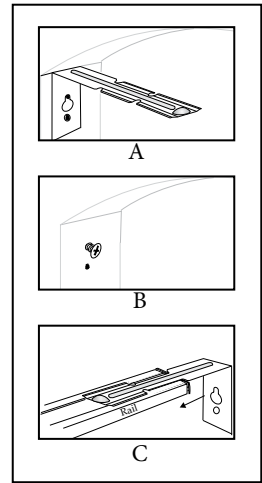

Side Mount

Minimum 2" surface

STEP 2: SHADE INSTALLATION

First, lower the bottom and/or middle rails about an inch. This will help keep the fabric from getting caught between the brackets and the head rail.

Hold the shade up near the brackets and insert the front clip of the bracket into the front groove of the rail.

Make sure the shade is centered in the window opening.

Push the rail back and up until the back clips of the bracket are inserted in the back groove of the rail.

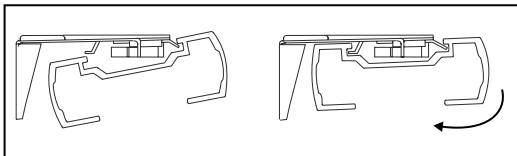

OPERATION

Press the button on the handle to raise or lower the moveable rails. The rails will stay in position when the button is released.

On a top down - bottom up shade the bottom rail can be raised and will push the middle rail up without having to depress the middle rail button. The middle rail button does need to be pressed to lower the middle rail.

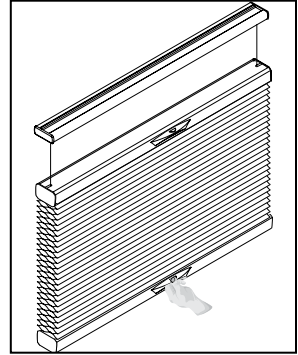

LEVEL THE MOVING RAIL(S) (IF NECESSARY)

If the bottom rail or the middle moving rail of a top down - bottom up shade is not level, it can be adjusted by following the procedure below.

- (1) Remove the right endcap from the rail that is not level.
- (2) Pull out the section labeled TOOL.
- (3) Support the rail with one hand and push in on the adjustment screw with the tool. Turn to adjust the rail. Turning clockwise will move the rail down, counterclockwise will move the rail up.
- (4) Be sure the adjustment screw pops out before letting go of the rail.

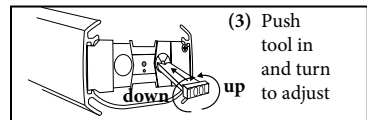
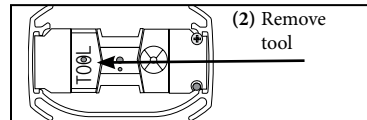
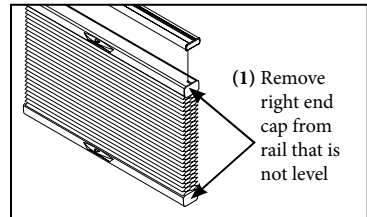

Note: The middle rail may need to be raised or lowered slightly to allow the adjustment screw to be pushed in.

When the rail is level, replace the tool and the endcap.

HOLD DOWN BRACKETS (OPTIONAL)

Optional hold down brackets are mounted with the supplied screws.

With the shade at its proper drop, place the pin of each hold down into the hole in each endcap and mark the screw holes. Make sure the pins are level and aligned.

Raise the shade, then screw the hold down bracket into the mounting surface.

Lower the shade. Slightly flex the hold down brackets to insert the pins into the endcaps.

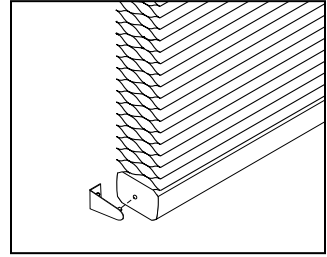

Hold Down Bracket

REMOVING THE SHADE

Push the head rail in toward the window.

Rotate the back of the head rail down away from the bracket.

As you release the brackets, support the head rail to keep it from falling.

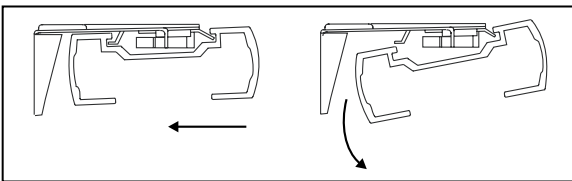

CLEANING AND CARE

The shade fabric is easy to care for. Regular dusting with a feather duster or vacuum cleaner brush is recommended. Most stains can be blotted with a damp sponge and mild detergent. Before using anything stronger than mild detergent and lukewarm water, test an unobtrusive corner of the shade. If you have any questions, call your dealer for advice.

TROUBLESHOOTING

Problem: Light gap between top and middle rail of a top down - bottom up shade.

Solution: If the end brackets were placed too far in, the head rail may bow causing a gap between rails. Remove shade and reposition end brackets so that they are 1" from the end.

Problem: Shade makes a ratcheting noise when raised or lowered.

Solution: Press firmly on the button to raise and lower.

Problem: Right side of shade has fallen down.

Solution: Support the rail with one hand and push in adjustment tool. Turn counter clockwise until the rail rises back up to level. Be sure adjustment screw pops out fully before releasing rail. (See level the moving rail section.)